

# Aeropuerto Internacional de Kansai

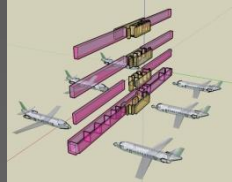

## CIRCULACIONES Y PUNTOS FIJOS

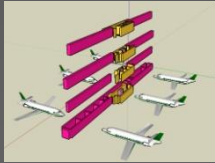

## CORTE AXONOMETRICO

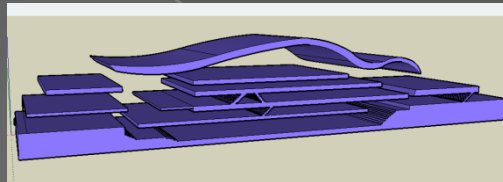
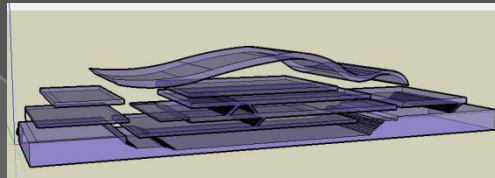

## INFOGRAMA

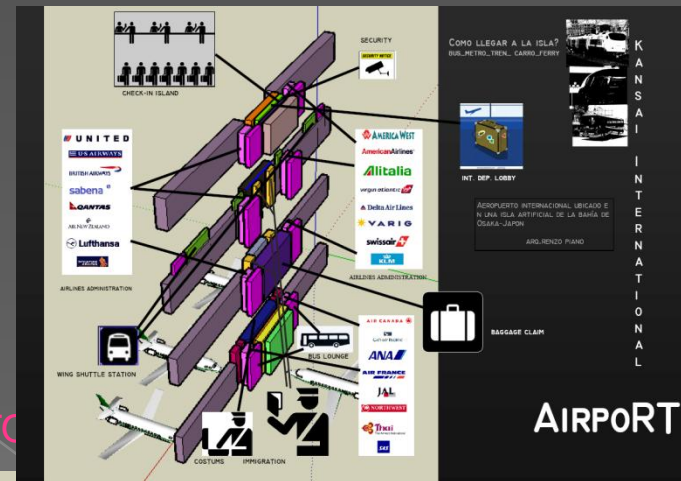

## ZONIFICACION

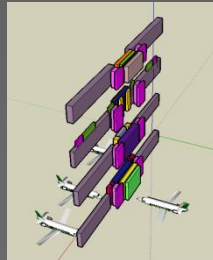
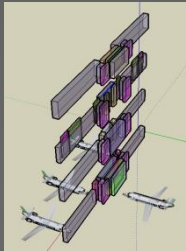

## EDIFICIO COMPLETO



## ESTRUCTURA

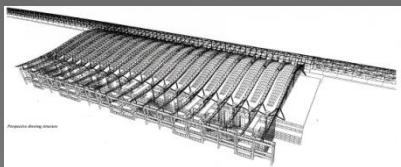

DIANA ALARCON  
ADRIANA BENALCAZAR  
DANIELA MOLINA

ARQUITECTURA 4º NIVEL  
10 / JULIO / 2009